

Item number: 1452878

Instruction manual

Ceiling light

McShine „LD-BW“

18 W, 1950 lm, Ø25 cm, 3000 K, warm white



TECAL DATA

Operating voltage:	220 – 240 V
Light color:	warm white
Color temperature:	3000 K
Power consumption:	18 W
Lifetime:	20000 h
Illumination technology:	LED
Outer diameter:	250 mm
Height:	50 mm
Energy efficiency class:	This product contains a light source of energy efficiency class G
Replaceable decorative ring:	Yes

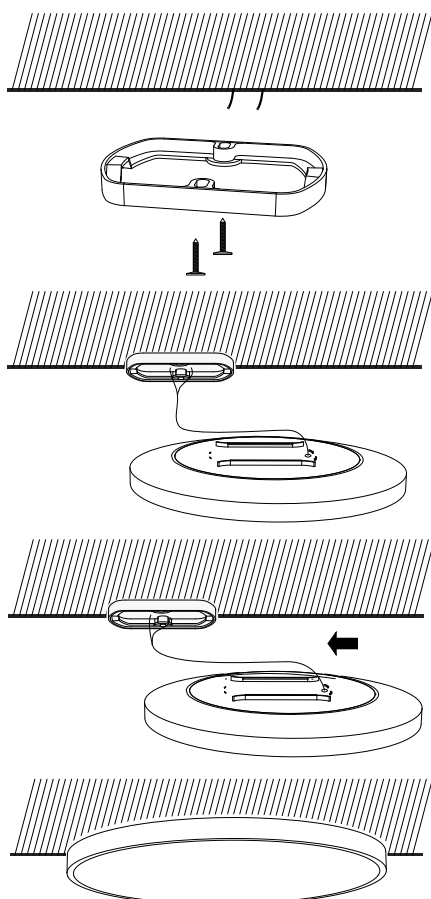

ASSEMBLY INSTRUCTIONS

- First, turn off the circuit breaker.
- The absence of voltage should be determined using a suitable measuring device.
- With the help of the mounting frame, mark the drill holes at the desired location.
- Using a suitable drill and observing the safety instructions, drill the mounting holes, and attach the mounting frame to the wall or ceiling using suitable dowels and screws.
- For connecting the power cable, a terminal block or screw strip should be used.
- Please connect the power cable of the products to the power cable by following the rule:
L to L, N to N, isolate green-yellow.
- Then, insert the lamp into the mounting frame.
- Turn the circuit breaker back on and check the function of the lamp.

REPLACING THE DECORATIVE RING

- Gently grasp the decorative ring on one side and pull it towards the lampshade to remove it.
- Place the new ring with the lampshade inserted onto the lamp and begin pressing the decorative ring gently but firmly against the fixture on one side.
- Work your way around in small steps, ensuring that the ring sits evenly and no parts protrude or get caught.

Item number: 1452878

EN

SAFETY INSTRUCTIONS

- Before putting the device into operation, check it for any damage. If damage is found, please do not operate the device.
- Please be aware that any technical modification to the device will immediately invalidate its approval.
- Keep the user manual for the device.
- Do not look directly into the light source to avoid eye injury.
- When drilling, protect your eyes with safety goggles.
- Wearing gloves while drilling is prohibited, as the glove could get caught in the rotating drill.
- Do not drop the device. It could be damaged upon impact on a hard surface.
- Avoid installation in places with significant temperature variations or high humidity.
- Do not leave packaging materials lying around; plastic films/bags, Styrofoam parts, etc., could become a dangerous toy for children.
- The device is not intended for children; it is not a toy!

CARE INSTRUCTIONS

- Do not use damaged cables. New cables must have the same characteristics as the original.
- Clean only with a soft cloth and neutral detergent. Avoid using alcohol or cleaning agents containing acetone, sulfur, beryllium, ammonia or other solvents.
- Avoid mechanical pressure and heavy contamination.
- The replacement of the lamp can only be provided by the manufacturer.

GENERAL NOTES

- Only use supplied original parts.
- The product has a replaceable frame that can be changed.
- Do not attempt to open or repair the product.

INTENDED USE

- The product is suitable for indoor use.
- The product must only be used for its intended purpose, as described in this user manual

DISPOSAL INSTRUCTIONS

By separating materials, recycling and disposing of old equipment in this way, you are making an important contribution to protecting our environment.

Packaging can be disposed of free of charge at the appropriate collection points:

- Paper in the paper bin
- Plastics in the yellow bag
- Glass in the used glass container

WEEE disposal note

According to the European WEEE Directive, electrical and electronic WEEE Directive, electrical and electronic equipment must not be disposed of with household waste.

Their components must be recycled or disposed of separately, because toxic and hazardous components can cause lasting damage to health and the environment if disposed of improperly.

As a consumer, you are obliged under the Electrical and Electronic Equipment Act (ElektroG) to return electrical and electronic equipment free of charge at the end of its service life to the manufacturer, the point of sale or to public collection points set up for this purpose.

Details are regulated by the respective state law.

The symbol of the wheeled garbage can on the product, the operating instructions and/or the packaging refers to these regulations. regulations.

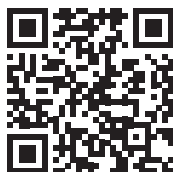

A multilingual version of this manual and the Declaration of Conformity can be found at the following link:

<http://ettgroup.de/product/1452878>